

Team

PUMPTEC

MANUFACTURER OF HIGH EFFICIENCY PUMPS & SYSTEMS

Series 205

The "Tool Kit" used to disassemble pump to its basic components and reassemble is a simple **HEX RANCH!**

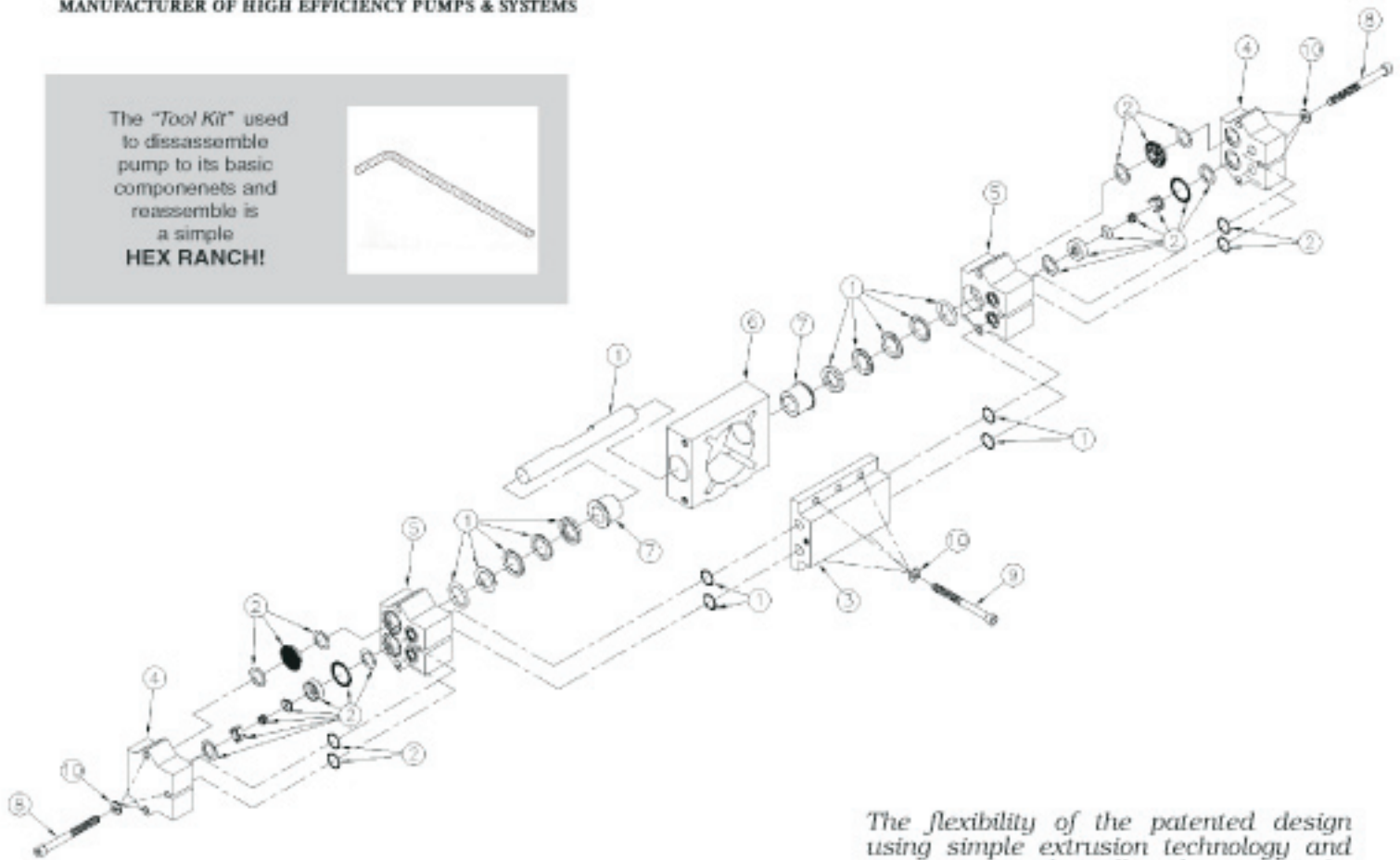

The flexibility of the patented design using simple extrusion technology and inexpensive tooling allow this pump to be modified or specially configured to meet unique customer requirements with very short concept to production lead times.

205V SCHEMATIC

#	P/N	DESCRIPTION	QTY
1	C-205V-KIT-A	KIT-A, 205V, BUNA	1
2	C-205V-KIT-B-M	KIT-B, 205V, TYPE M VALVES, BUNA	1
3	0205-0504-0004	MANIFOLD, 205V, ANODIZED, BLUE	1
4	0205-0502-0007	HEAD, 205V, ANODIZED, BLUE, 3-3/8" PORTS	2
5	0205-0503-0001	STUFFING BOX, 205V, ANODIZED, BLUE	2
6	0205-0507-0001	CRANKCASE, 205V, ANODIZED, BLUE	1
7	0204-0010-0002	PLUNGER GUIDE, 204/205	2
8	BOLT-1/4-20 X 2 3/4-SHCS-SS	BOLT, 1/4-20 x 1-1/4, SHCS, STAINLESS STEEL	6
9	BOLT-1/4-20 X 2 -SHCS-SS	BOLT, 1/4-20 x 2-1/2, SHCS, STAINLESS STEEL	4
10	WSH-FLAT-M6-SS	WAHER, FLAT, M6, STAINLESS STEEL	10

* KIT-C NOT SHOWN.